

Metric Hex Bolt DIN931 (EN4014) ZP

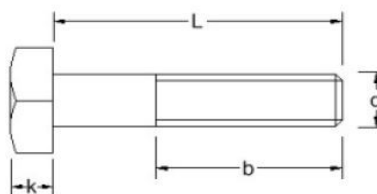
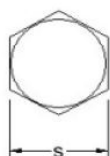

Length/dim	M5	M6	M8	M10	M12	M14	M16	M18	M20	M22	M24	M27	M30	M33	M36
b (Max)	16	18	22	26	30	34	38	42	46	50	54	60	66	72	78
b (Max) (L >125mm)	22	24	28	32	36	40	44	48	52	56	60	66	72	78	90
b (Max) (L >200mm)	34	36	40	44	48	52	56	60	64	68	72	78	84	90	96
k (Min)	3.35	3.85	5.15	6.22	7.32	8.62	9.82	11.28	12.28	13.78	14.78	16.65	18.28	20.58	22.1
Pitch	0.8	1	1.25	1.5	1.75	2	2	2.5	2.5	2.5	3	3	3.5	3.5	4
s	8	10	13	17	19	22	24	27	30	34	36	41	46	50	55
Length/dim	M5	M6	M8	M10	M12	M14	M16	M18	M20	M22	M24	M27	M30	M33	M36
25	✓														
30	✓	✓	✓												
35	✓	✓	✓	✓	✓										
40	✓	✓	✓	✓	✓										
45	✓	✓	✓	✓	✓										
50	✓	✓	✓	✓	✓	✗	✓								
55	✓	✓	✓	✓	✓	✗	✓								
60	✓	✓	✓	✓	✓	✗	✓	✗	✓						
65	✓	✓	✓	✓	✓	✗	✓	✗	✓						
70	✓	✓	✓	✓	✓	✗	✓	✗	✓	✗	✓				
75	✓	✓	✓	✓	✓	✗	✓	✗	✓	✗	✓				
80	✓	✓	✓	✓	✓	✗	✓	✗	✓	✗	✓	✗	✓		
85	✓	✓	✓	✓	✓	✗	✓	✗	✓	✗	✓	✗	✓		
90	✓	✓	✓	✓	✓	✗	✓	✗	✓	✗	✓	✗	✓	✗	
95	✓	✓	✓	✓	✓	✗	✓	✗	✓	✗	✓	✗	✓	✗	✗
100	✓	✓	✓	✓	✓	✗	✓	✗	✓	✗	✓	✗	✓	✗	✗
105	✗	✗	✗	✗	✗	✗	✗	✗	✗	✗	✗	✗	✗	✗	✗
110		✓	✓	✓	✓	✗	✓	✗	✓	✗	✓	✗	✓	✗	✗
120		✓	✓	✓	✓	✗	✓	✗	✓	✗	✓	✗	✓	✗	✗
130		✓	✓	✓	✓	✗	✓	✗	✓	✗	✓	✗	✓	✗	✗
140		✓	✓	✓	✓	✗	✓	✗	✓	✗	✓	✗	✓	✗	✗
150		✓	✓	✓	✓	✗	✓	✗	✓	✗	✓	✗	✓	✗	✗
160				✓	✓	✗	✓	✗	✓	✗	✓	✗	✓	✗	✗
170				✓	✓	✗	✓	✗	✓	✗	✓	✗	✓	✗	✗
180				✓	✓	✗	✓	✗	✓	✗	✓	✗	✓	✗	✗
190				✓	✓	✗	✓	✗	✓	✗	✓	✗	✓	✗	✗
200				✓	✓	✗	✓	✗	✓	✗	✓	✗	✓	✗	✗
210					✗		✓		✓		✓	✗	✓	✗	✗
220					✗		✓		✓		✓	✗	✓	✗	✗
230					✗		✓		✓		✓	✗	✓	✗	✗
240					✗		✓		✓		✓	✗	✓	✗	✗
250					✗		✓		✓		✓	✗	✓	✗	✗
260					✗		✓		✓		✓	✗	✓	✗	✗
270					✗		✓		✓		✓	✗	✓	✗	✗
280					✗		✓		✓		✓	✗	✓	✗	✗
290					✗		✓		✓		✓	✗	✓	✗	✗
300					✗		✓		✓		✓	✗	✓	✗	✗

✓ = Indicates sizes normally available from stock or on short lead time.
✗ = Indicates sizes available to order (subject to minimum order quantity)